

**RUSH
WITT &
WILSON**



**RUSH
WITT &**

10 Eversley Crescent, St. Leonards-On-Sea, TN37 6QF
Guide Price £260,000 - £270,000

*****GUIDE PRICE £260,000 - £270,000***** Rush Witt & Wilson welcome to the market this charming mid-terrace house located on Eversley Crescent in the picturesque town of St. Leonards-On-Sea. Upon entering, you are greeted by an open plan reception room/dining room, perfect for relaxing with family and friends. The property boasts **THREE** bedrooms, offering ample space for a growing family or those in need of a home office. The house features a shower room and separate W/C, ensuring convenience for all residents. With off-road parking available for one vehicle, you'll never have to worry about finding a parking spot after a long day. One of the highlights of this property is the gated entrance, providing an extra layer of security and privacy. Additionally, the separate garden plot offers a tranquil outdoor space where you can unwind and create the perfect space to enjoy. The main rear garden is of low maintenance and offers a great space to entertain. This mid-terrace house is ideal for those seeking a retreat while still being close to local amenities. Don't miss the opportunity to make this your new home.







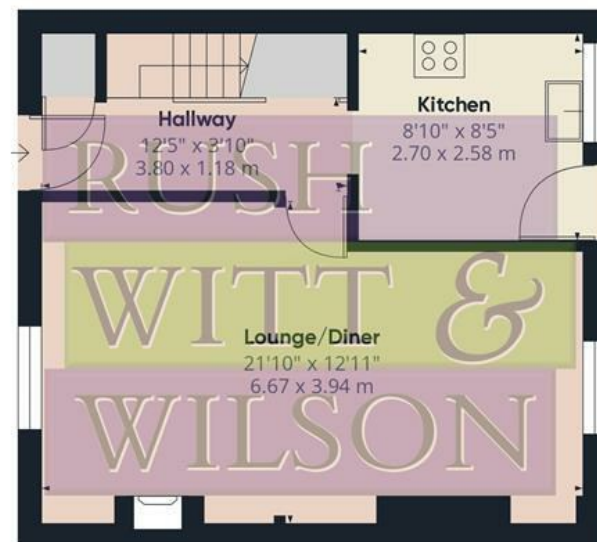

Floor 0



Floor 1

Approximate total area⁽¹⁾

805.95 ft²

74.88 m²

(1) Excluding balconies and terraces

While every attempt has been made to ensure accuracy, all measurements are approximate, not to scale. This floor plan is for illustrative purposes only.

GIRAFFE 360

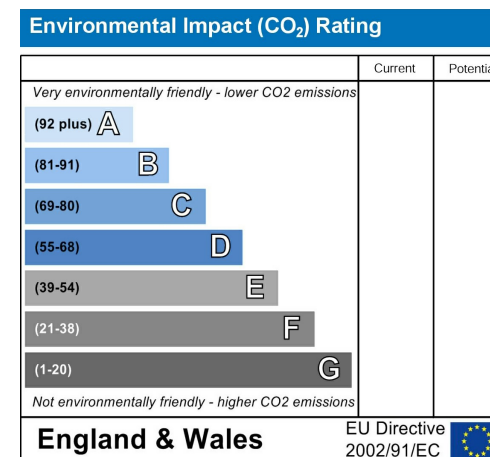
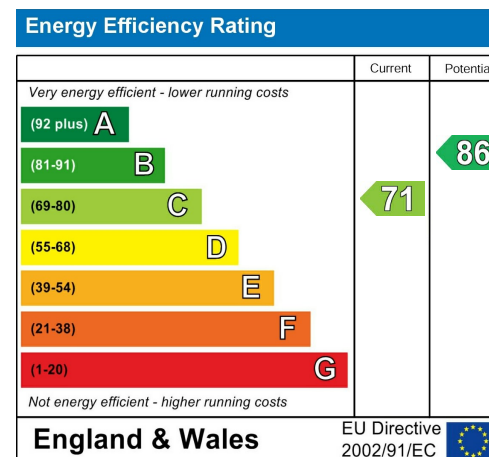
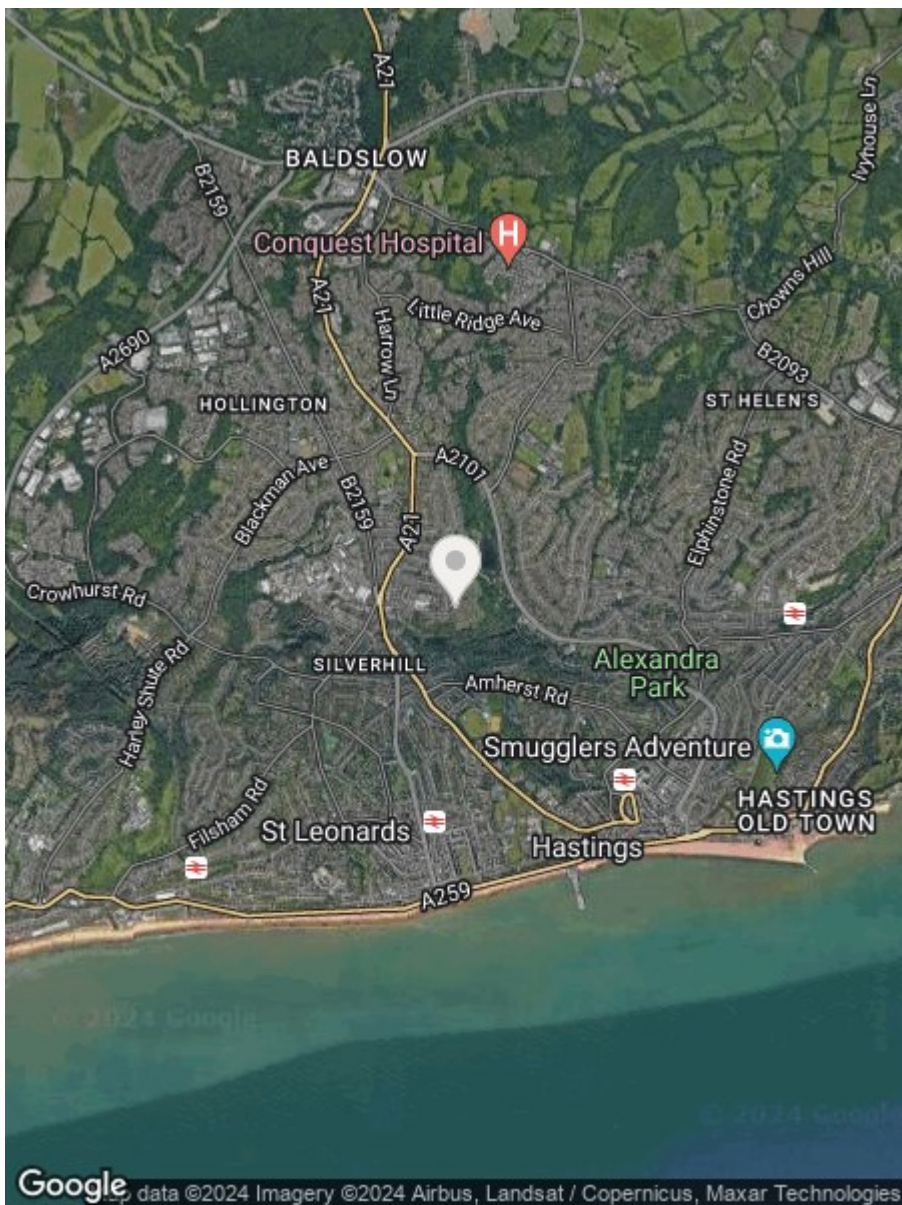

**RUSH
WITT &
WILSON**

Residential Estate Agents
Lettings & Property Management



Rother House Havelock Road
Hastings
East Sussex
TN34 1BP
Tel: 01424 442443
hastings@rushwittwilson.co.uk
www.rushwittwilson.co.uk